

TABULATIONS

PAD 2:	TOTAL 1.37 AC.
RETAIL 'A'	11,130 SF.
PARKING (PROVIDED)	83 SPACES (1/134 SF)
PAD 3:	TOTAL 1.34 AC.
RETAIL 'B'	13,150 SF.
PARKING (PROVIDED)	48 SPACES (1/273 SF)

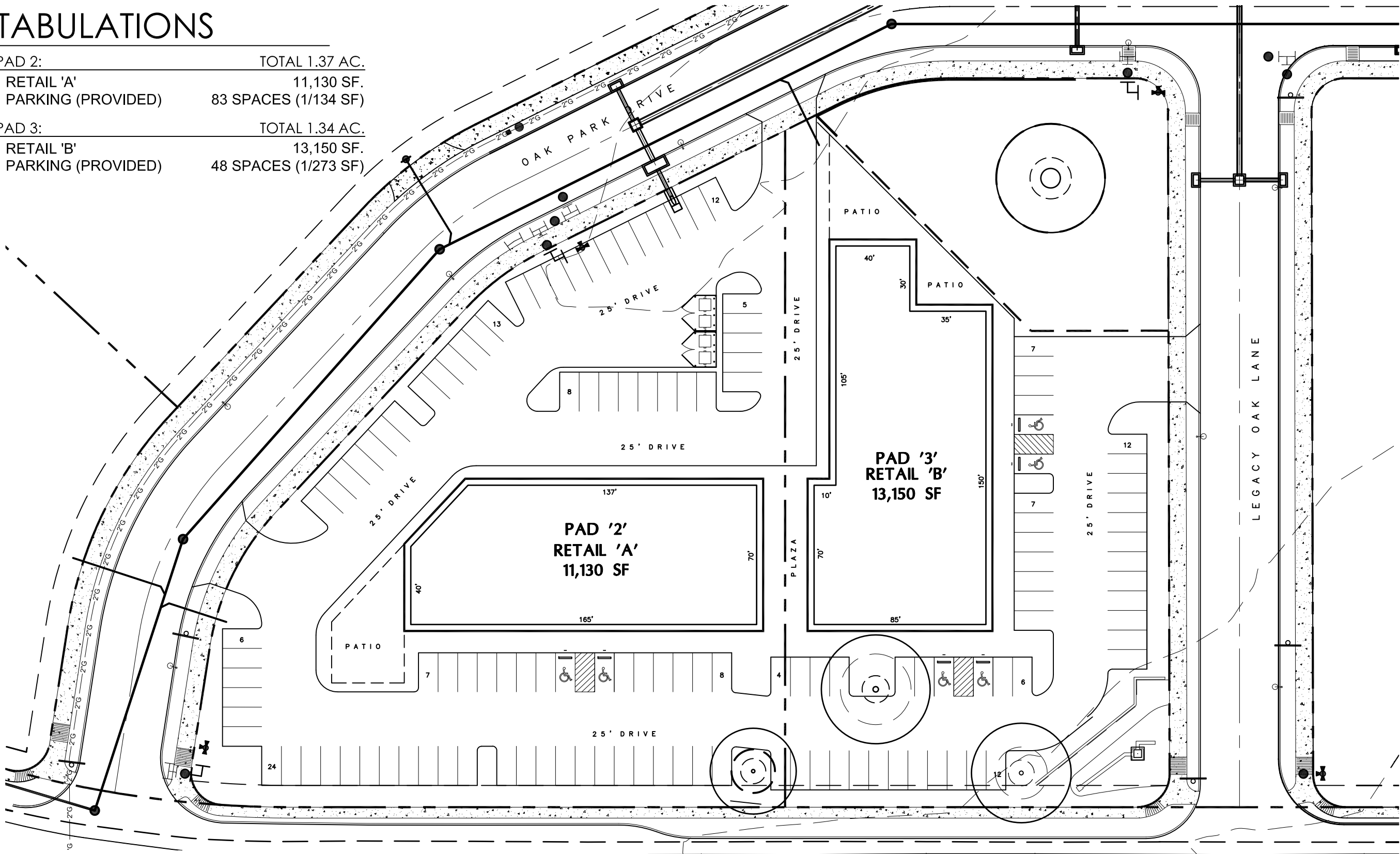

PROPOSED SITE DEVELOPMENT PLAN

SCALE: GRAPHIC

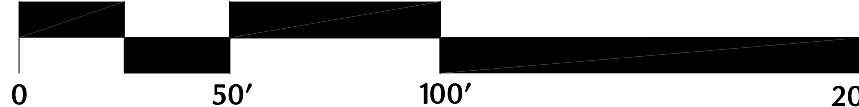

NORTH

CONCEPTUAL PLAN ONLY. NOT TO BE RELIED UPON UNTIL FINALIZED

THIS CONCEPTUAL SITE PLAN IS FOR MARKETING PURPOSES ONLY, AND HAS BEEN PREPARED FOR CLIENT BASED UPON PRELIMINARY AVAILABLE SITE INFORMATION DEEMED RELIABLE. ALL DIMENSIONS, GRADES AND AREA CALCULATIONS ARE SUBJECT TO VERIFICATION AND MODIFICATION BY A PROFESSIONAL CIVIL ENGINEER FOR COMPLIANCE WITH ALL NATIONAL, STATE, AND LOCAL REGULATIONS. NOT FOR REGULATORY APPROVAL, PERMITTING, OR CONSTRUCTION.

SP1-072722