

LEGEND

- RW PROPOSED RECYCLED WATER LINE
- W PROPOSED WATER LINE
- SS PROPOSED SANITARY SEWER LINE

NORTH

GRAPHIC SCALE IN FEET
0 100 200 400

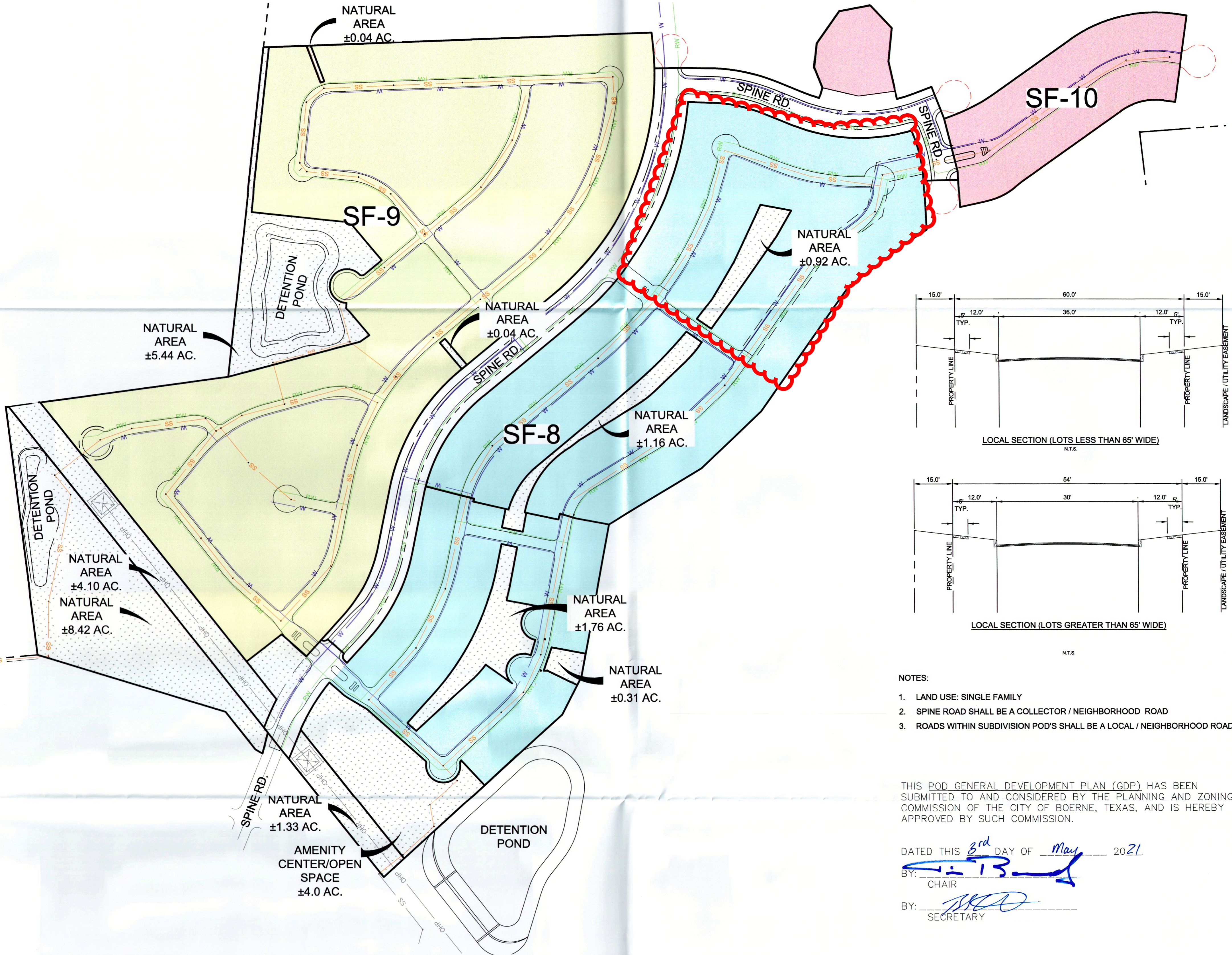

- NOTES:**
1. LAND USE: SINGLE FAMILY
 2. SPINE ROAD SHALL BE A COLLECTOR / NEIGHBORHOOD ROAD
 3. ROADS WITHIN SUBDIVISION POD'S SHALL BE A LOCAL / NEIGHBORHOOD ROAD

THIS POD GENERAL DEVELOPMENT PLAN (GDP) HAS BEEN SUBMITTED TO AND CONSIDERED BY THE PLANNING AND ZONING COMMISSION OF THE CITY OF BOERNE, TEXAS, AND IS HEREBY APPROVED BY SUCH COMMISSION.

DATED THIS 3rd DAY OF May 2021
 BY: *[Signature]*
 CHAIR
 BY: *[Signature]*
 SECRETARY

SUMMARY					
POD	LOT WIDTH	LOT DEPTH	RESIDENTIAL COUNT	DENSITY (LOTS/ACRE)	ACREAGE
SF-8	45	130	74	4.4	16.8
	55	130	66	4.4	14.9
	65	130	45	4.4	10.2
SF-9	50	120	50	3.6	13.8
	60	125	71	3.6	19.6
	70	130	64	3.6	17.7
SF-9	50	130	30	4.3	6.9
NATURAL AREA (OPEN SPACE, DETENTION, AMENITY)	-	-	-	-	27.52
SPINE ROAD	-	-	-	-	13.5
TOTAL	-	-	401	-	-

POD GENERAL DEVELOPMENT PLAN (GDP)

TRANSPORTATION NETWORK PLAN & OPEN SPACE SYSTEM PLAN



PODS SF-8, SF-9 AND SF-10

Kimley»Horn
 601 NW LOOP 410, SUITE 350, SAN ANTONIO, TEXAS 78216
 PHONE: 210-541-9166 FAX: 210-541-8699
 WWW.KIMLEY-HORN.COM
 © 2021 KIMLEY-HORN AND ASSOCIATES, INC.
 TBPE Firm No. 928

Drawing name: K:\SNA_Civil\068686326-Esperanza2021\CAD\Exhibits\POD GDP\POD-GDP-SF8-9-10.dwg POD G.D.P. Apr 29, 2021 2:30pm by: javier.ortozco
 This document, together with the concepts and designs presented herein, as an instrument of service, is intended only for the specific purpose and client for which it was prepared. Reuse of and improper reliance on this document without written authorization and adaptation by Kimley-Horn and Associates, Inc. shall be without liability to Kimley-Horn and Associates, Inc.